



# Liberty Homes, Inc.



St. Rd. 13, P.O. Box 308  
Syracuse, IN 46567

www.libertyhomesinc.com

E-Mail: LIBERTYHOMES@INTERMETMCI.COM

*120  
Raymond St*

**(219) 457-3121**

**1-800-366-5974**

**(219) 457-2203 Sales Fax**

## FROM THE DESK OF: JIM DAVIS

Date: 12/14/01 To: Bev's Demand

Page 1 of 1

*Mr. Demand: Here's the info you requested on H&O*

*Cont.*

*[Signature]*

*Jim Davis*

PLEASE CONTACT THE ABOVE PARTY IMMEDIATELY IF TRANSMISSION IS INCOMPLETE. THANK YOU.

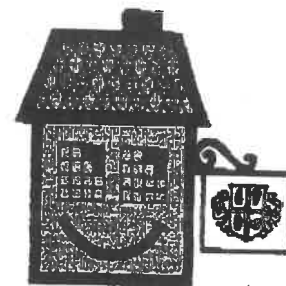
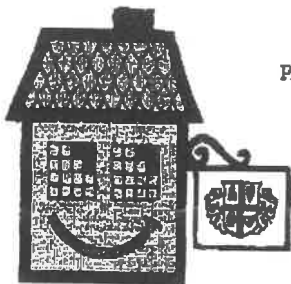



**FAX COVER SHEET**  
**ENGINEERING / DESIGN**

Liberty Homes Inc.  
1101 Eisenhower Dr. N.  
Goshan IN. 46527  
Fax: 219-533-3325  
Tel: 219-533-0431

TO: JIM DAVIS

FROM: LEE LEHMAN

DATE: \_\_\_\_\_

TIME: \_\_\_\_\_ AM - PM

Total number of pages including cover :

**FAX STATUS:**

- URGENT
- FOR YOUR INFORMATION
- PLEASE CALL AFTER REVIEW OF THE ATTACHED FAXED PAGES.
- I WILL CALL YOU SHORTLY TO REVIEW THE ATTACHED FAXED PAGES.
- 

**MAILING STATUS:**

- HARD COPIES OF FAXED PAGES WILL BE MAILED.
- NO ADDITIONAL COPIES WILL BE MAILED.

Comments: HOPE THIS DOES THE  
JOB.

Please contact the above party immediately  
if transmission is incomplete.



**LIBERTY HOMES, INC.**

**Corporate Office**

December 14, 2001

To Whom It May Concern:

Please be advised that Liberty Homes are all manufactured in accordance with the HUD Manufactured Housing Construction and Safety Standard Act of 1974. This is evidenced by a label of compliance affixed to each home's exterior that is issued by an independent inspection agency, assuring compliance to those standards.

If you require additional information, please do not hesitate to contact me.

Sincerely,

LIBERTY HOMES, INC.

A handwritten signature in black ink, appearing to read "Lee Lehman". The signature is written in a cursive style and is positioned above the printed name and title.

Lee Lehman  
Director of Engineering

seh



# Liberty Homes, Inc.

St. Rd. 13, P.O. Box 308  
Syracuse, IN 46567



www.libertyhomesinc.com

E-Mail: LIBERTYHOMES@INTERMETMCI.COM

**(219) 457-3121**

**1-800-366-5974**

**(219) 457-2203 Sales Fax**

## FROM THE DESK OF: JIM DAVIS

Date: 12/12/01 To: Brent Simon

Page 1 of 3

*Brent: Here's the 5.5/12 Roof Truss Print*

*you requested for S & K Homes in Nashville, TN.*

*Feel free to call if any questions.*

PLEASE CONTACT THE ABOVE PARTY IMMEDIATELY IF TRANSMISSION IS  
INCOMPLETE. THANK YOU.

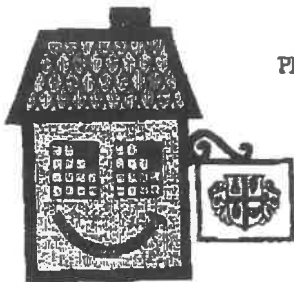



DESIGN	LOADS @	24 IN C/C	LUMBER	MARK
AN 13.13	TOP CHD 30	PSF LL	TOP CHD 2X3 STANDARD	SPF (T1)
AGING 24	TOP CHD 10	PSF DL	TOP CHD 2X3 STANDARD	SPF (T2)
WEAR	BOT CHD 10	PSF DL	BOT CHD 1-11/16 X 1-1/2	SPF (B1)
DE	BOT CHD 50	PSF	BOT CHD 1-11/16 X 1-1/2	SPF (B2)
ATE MFG. TEEBOK 20 DA	TOTAL		WEBS 1-11/16 X 1-1/2	SPF (W1)
	ALL LOADS @	16 IN C/C	WEBS	SPF (W2)
	TOP CHD 45	PSF LL	WEBS 2X3 NO. 3	SPF (W3)
	TOP CHD 15	PSF DL		OTHERS
	BOT CHD 15	PSF DL		
	TOTAL	PSF		

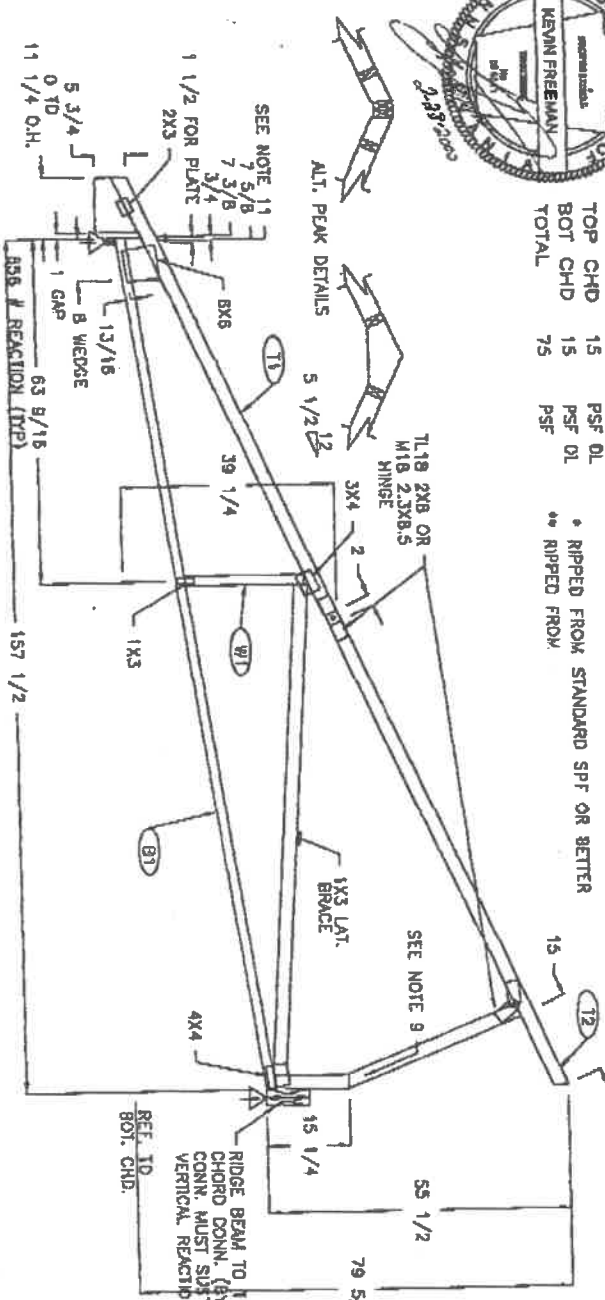

• ARRANGEMENTS POINT TO LENGTH DIMENSIONS  
 • ALL PLATE LIBERTY DIMENSION IN DIRECTION OF IDENTIFIED PLATE RULES  
 • DO NOT SCALE THIS DRAWING FOR DIMENSIONS  
 • ALL DIMENSIONS IN INCHES UNLESS NOTED OTHERWISE  
 • ALL PLATES PLACED SYMMETRICALLY ON JOINTS UNLESS NOTED OTHERWISE

1) MHCCSS SEC. 3280.303, 3280.304, 3280.305, 3280.402  
 2)  
 3)

CONFORMITY WITH THESE SECTIONS AND PROCEDURES DOES NOT NECESSARILY INSURE COMPLIANCE WITH ALL GOVERNING ORDINANCES, LAWS AND CODES. THE BUILDING ARCHITECT OR ENGINEER IS RESPONSIBLE TO AFFIRM ALL APPLICABLE REGULATIONS ARE SATISFIED.

USE OF THIS STRUCTURAL COMPONENT IN A COMPLETE STRUCTURE MUST BE AT THE SPECIFICATION OF THE DESIGNER OF SAID COMPLETE STRUCTURE. ALL LATERAL BRACING SPECIFIED HEREON IS FOR BRACING INDIVIDUAL TRUSS MEMBERS ONLY. RESTRICTING LATERAL BRACING AND ADDITIONAL BRACING PROVIDED BY DESIGNER TO COMPLETE STRUCTURE.

UNIVERSAL FOREST PRODUCTS, INC.  
 3153 THREE MILE RD., N.E.  
 GRAND RAPIDS, MICHIGAN 49505  
 PHONE: (616) 354-6161

SCALE	9/16"=1'
DATE	02-22-00
DRAWN BY	MA
CHECKED BY	
APPROVED BY	
JOB	13805

UNIVERSAL FOREST PRODUCTS, INC.	
CORPORATE OFFICES - GRAND RAPIDS, MI.	
DRAWING FOR	LIBERTY
TITLE	HINGE-CATHEDRAL
DRAWING NO.	HC1109R04

**PFS LISTED**  
 DATE: JUN 15 1998  
 PFS CORPORATION, MADISON, WI

SEE NOTE 9  
 RIDGE BEAM TO TRUSS BOTTOM CHORD CONN. (BY OTHERS) CONN. MUST SUSTAIN 850# VERTICAL REACTION

- NOTES:**
- 1) MAX. PURLIN SPACING = 24" FT. N.A.
  - 2) MANUFACTURING TOLERANCES 1/4 IN OVERALL HEIGHT 1/4 IN OVERALL LENGTH
  - 3) ALL VERTICAL POST PLACEMENT 1/4 IN ON-SITE CONNECTIONS MUST SUSTAIN A MINIMUM OF 8'S LOAD.
  - 4) ALL CONNECTOR PLATES ARE TO BE INSTALLED ON BOTH SIDES UNLESS OTHERWISE INDICATED.
  - 5) BEARING ARROW INDICATE 1-1/2" BEARING UNLESS OTHERWISE INDICATED.
  - 6) BOTTOM CHORD MEMBER 8/32 IN.
  - 7) FOR 1X2'S PROVIDE 4 TECTA BITE (MIN) INTO EACH MEMBER (PER PLATE, PER SIDE). OVERHANG AND/OR SOFTY BLOCK MAY BE CUT BACK UP TO THE HEEL OF THE TRUSS AS NEEDED. OVERHANG MAY BE MFG. AT ANY LENGTH UP TO THE MAXIMUM SHOWN.
  - 8) AXIAL LOAD = 321# COMPRESSION SNOW LOAD I = 40# TENSION
  - 9) PROVISIONS MUST BE MADE TO PREVENT LATERAL MOVEMENT OF THE TOP CHORD DURING TRANSPORTATION. TRUSS MAY BE CUT ALONG VERT. LINE REF. TO ARROW.
  - 10) VERT. LINE REF. TO ARROW.
  - 11) PFS NO. 95-523
  - 12) BASED ON HC1109R01
  - 13) CHANGES: INCREASE KNEEWALL TO 15-1/4", ADDED SOFTY BLOCK TO OVERHANG.

Revised KP 2 15-04

170150

9'-2 3/8" (8'-8 1/2")  
 19'-10 7/8" (8'-10 1/2")  
 10'-6 1/2"  
 30'-8 3/8"  
 47'-3 7/8"  
 12'-0"  
 59'-7 1/8" 64'-10 3/8"  
 5'-0"  
 10'-4 1/4" (10'-6 1/2")  
 5 1/8" (3 7/8")

(3 7/8") 5 1/8"  
 (18'-2 1/4") (18'-0 1/4")  
 18'-6 3/8"  
 14'-4 3/8"  
 33'-2 3/8"  
 26'-1 1/2"  
 59'-7 1/8" 64'-10 3/8"  
 5'-0"  
 (10'-8 1/4") (10'-4 1/2")  
 76'-0" (3 7/8")

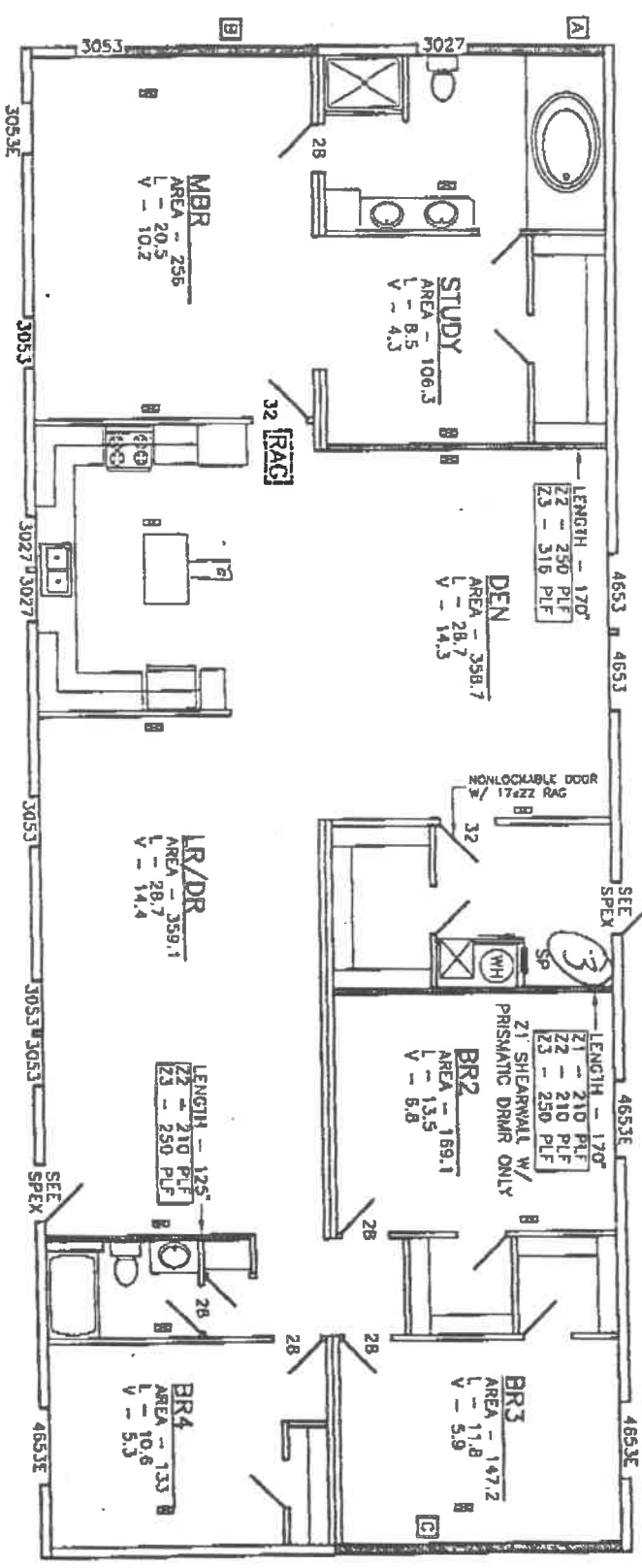

APPROVED BY  
**NIA INC.**  
 APR 30 1999

FEDERAL MANUFACTURED HOME  
 CONSTRUCTION AND SAFETY STANDARDS

TOTAL WINDOW AREA - 167.76 SQ. FT.

LENGTH	A	B	C
Z1	150 PLF	150 PLF	150 PLF
Z2	100 PLF	100 PLF	100 PLF
Z3	150 PLF	150 PLF	100 PLF

THE INFORMATION ON THIS PLAN IS PROPRIETARY

REVISED 30RD08C ID 328008C, REVISED SHEETWALL LENGTHS

MAAC 16 APR 99

JSB 14 OCT 98

DESCRIPTION

DAPLA PLAN

SECTION 61

328008

Raymond St

House in Napoleon.

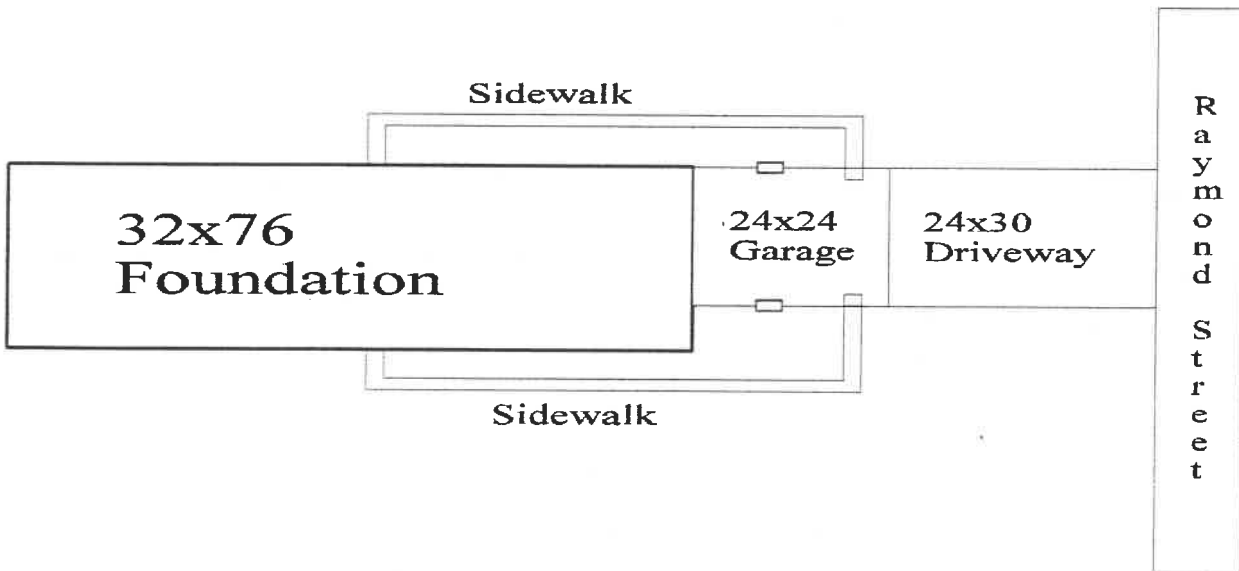

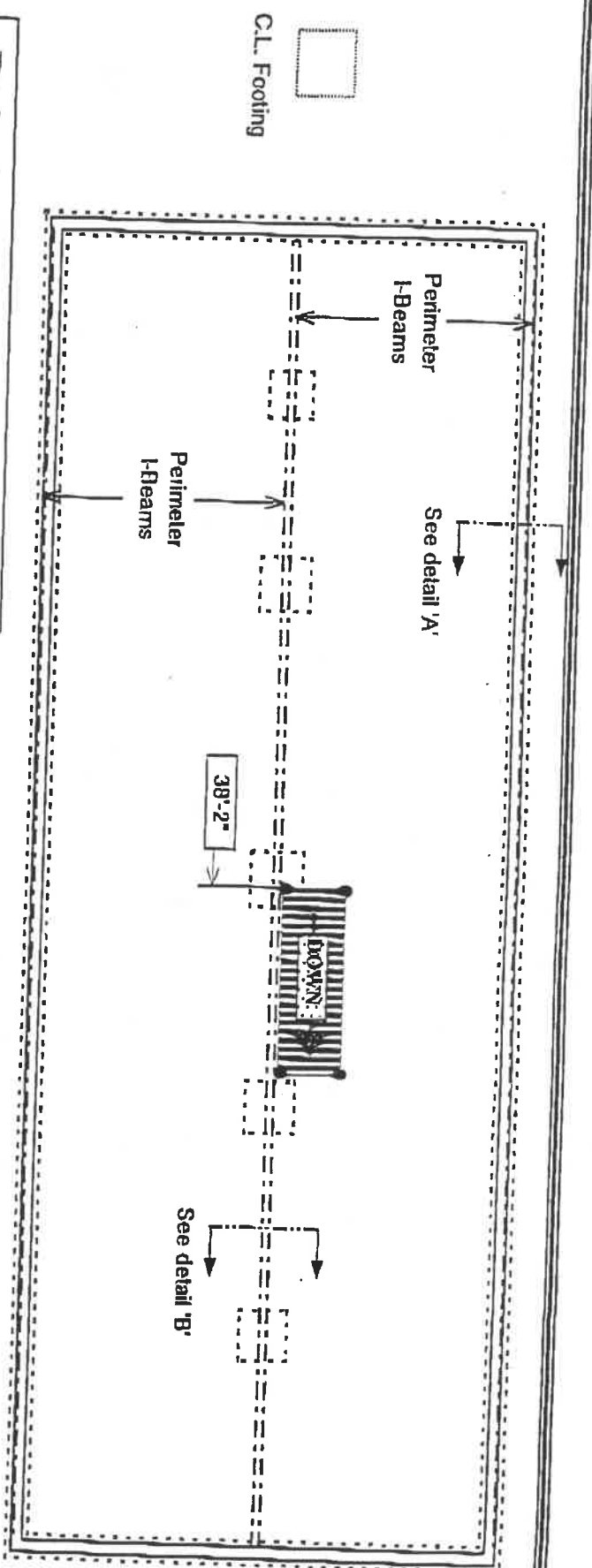

**Perimeter frame foundation detail.**

Total length of home : 26'-00"  
 Width of home : 30'-00"  
 Perimeter I-beams : 177" O.C.  
 Perimeter I-beams : M12x10.62

*This foundation system does not require cross beams.*

- NOTES:**
- 1 - 2500 PSF MIN. soil bearing capacity req'd.
  - 2 - Lally columns to be sized to support the given loads.
  - 3 - Refer to installation for permanent foundations for all other details.
  - 4 - Reference 90-40-0032 for units with side or front porch.

Total required numbers of center line footing : 5

Distance from rear of the home to :	Min. footing Size	Center line lally column & Footing Loads:
1st center line column footing:	10' 0"	32 "SQ. 17,541 #
2nd center line column footing:	20' 9"	37 "SQ. 23,247 #
3rd center line column footing:	37' 6"	38 "SQ. 25,082 #
4th center line column footing:	50' 5"	35 "SQ. 21,835 #
5th center line column footing:	63' 4"	34 "SQ. 20,569 #

**BASEMENT FOUNDATION DETAIL**

**DIVISION : Syr.**

Plant # : 1



Wind zone 1 only. ENG :  
 30 PSF Roof load Liberty F  
 MODEL 328008 Date: 4/12/01



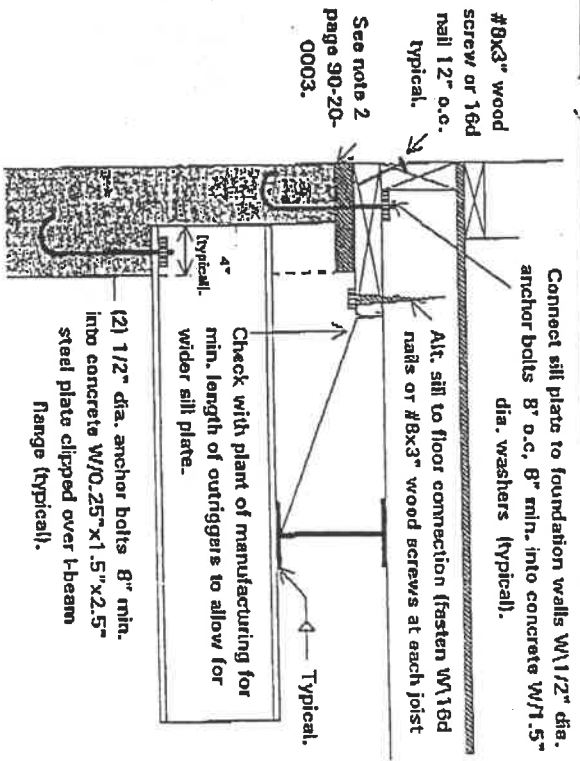

**SECTION 'B-B'**

**Main unit to foundation connections at sidewalls.**

\* Add 6" plaster or additional lally columns where main frame I-beams are recessed more than 4" from front or rear of floor (see basement for plaster location).

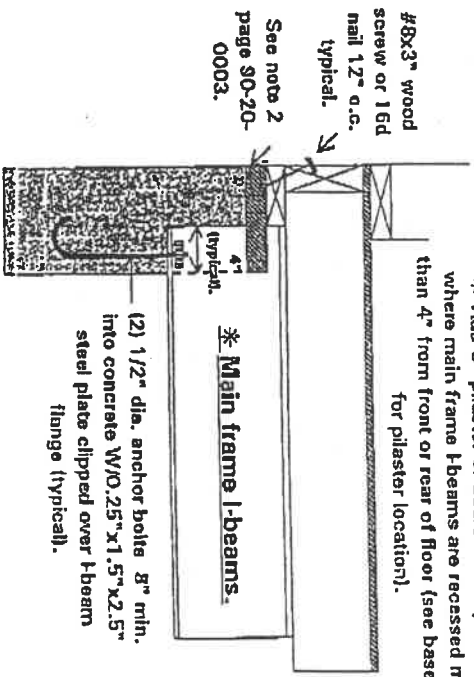

**SECTION 'C-C'**

**Main unit to foundation connections at endwalls.**

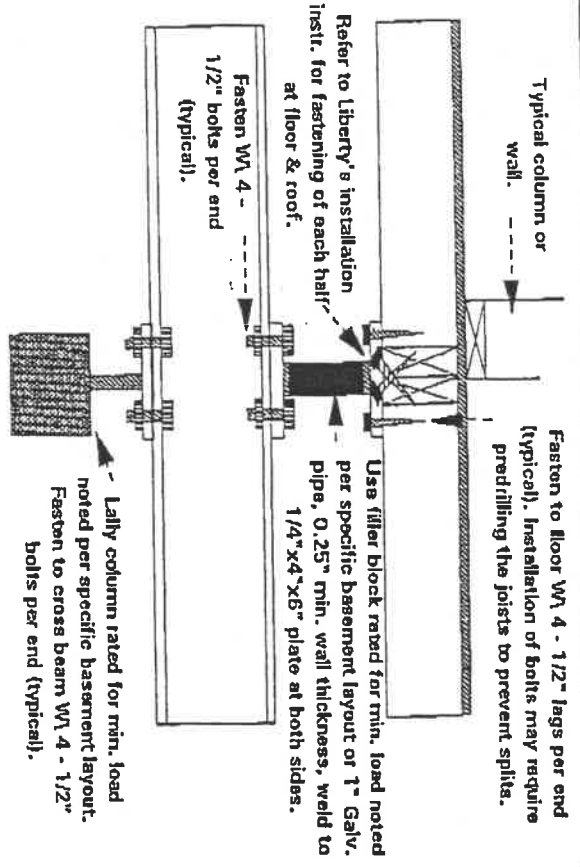

**Lally column to cross beam & floor connection (typical)**

Fasten column to floor W1/4 - 1/2 inch lags per end (typical). Installation of bolts may require predrilling the joists to prevent splits.

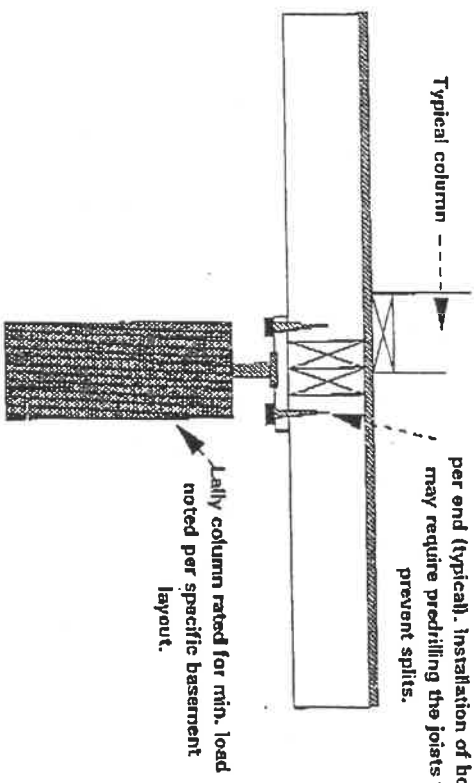

**Lally column to floor connection (typical when no cross beam is specified under floor)**

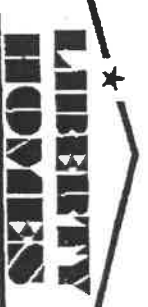

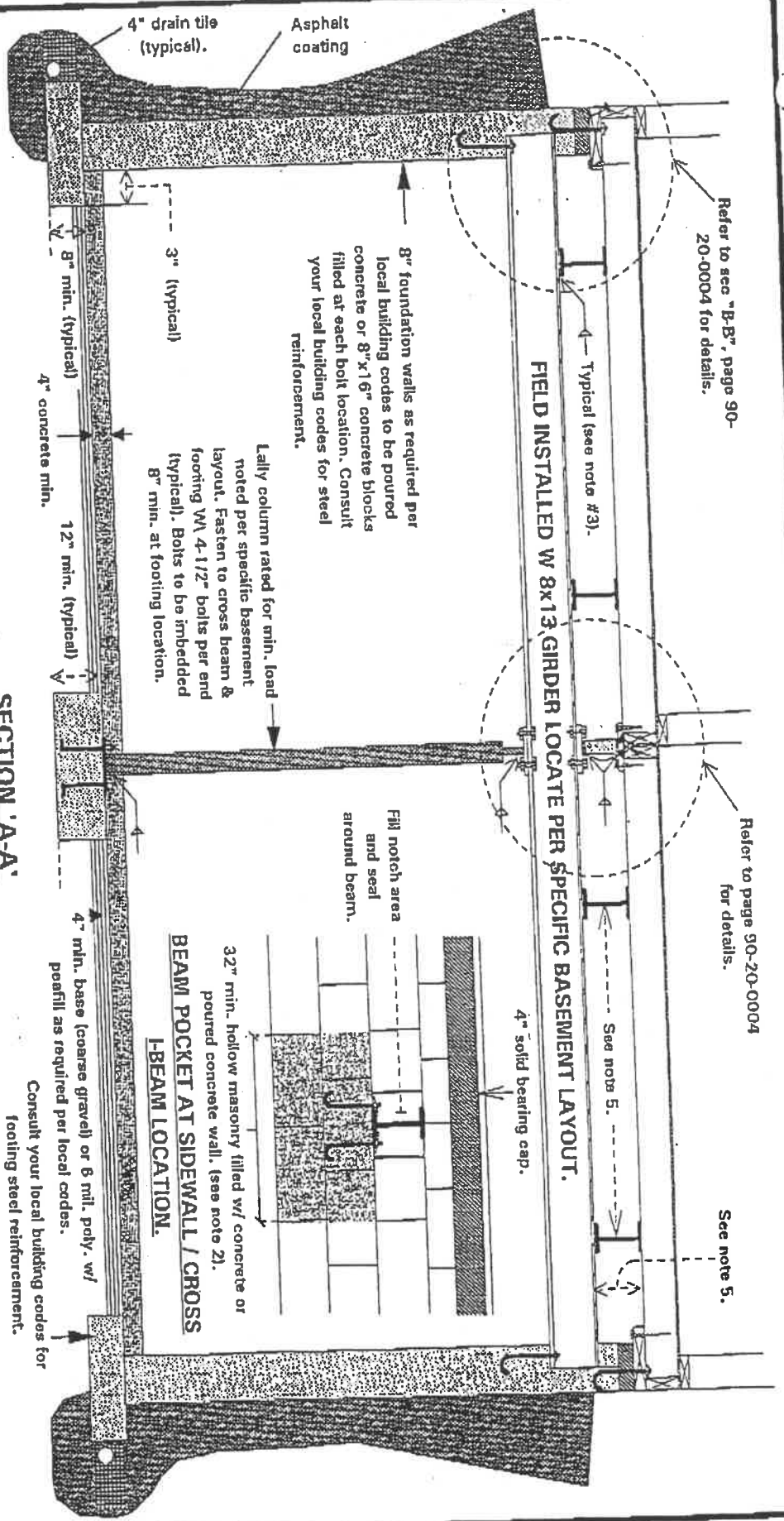

Refer to sec "B-E", page 90-20-0004 for details.

Refer to page 90-20-0004 for details.

See note 5.

FIELD INSTALLED W 8x13 GIRDER LOCATE PER SPECIFIC BASEMENT LAYOUT.

8" foundation walls as required per local building codes to be poured concrete or 8"x16" concrete blocks filled at each bolt location. Consult your local building codes for steel reinforcement.

Lally column rated for min. load noted per specific basement layout. Fasten to cross beam & footing w/ 4-1/2" bolts per end (typical). Bolts to be imbedded 8" min. at footing location.

Fill notch area and seal around beam.

32" min. hollow masonry filled w/ concrete or poured concrete wall. (see note 2).  
BEAM POCKET AT SIDEWALL / CROSS I-BEAM LOCATION.

4" min. base (coarse gravel) or 8 mil. poly. w/ peafill as required per local codes.

Consult your local building codes for footing steel reinforcement.

**SECTION 'A-A'**  
**Main unit to foundation requirements.**

- NOTES:**
1. Basement walls & footings to be designed and constructed to meet local soil conditions, energy and building codes.
  2. Foundation walls may be poured concrete (3000 psi min.) or 8"x16" precast concrete blocks for basement use. Blocks must be filled with concrete (32" min. x ht. of basement wall) at each anchor bolt & cross beam location. Block must be capped with 4" solid concrete.
  3. All welds to be E-70 1/8" min. fillet, full width.

4. Optional 12"x16" concrete pilasters may be used at transverse girder & foundation wall location.
5. Dimension varies with unit I-beam size. See your specific basement layout for size of I-beams.
6. Applicable to wind zone 1 only.
7. Refer to Liberty's installation instructions for all other information.

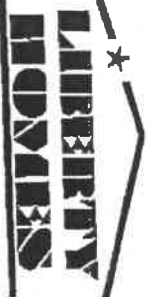

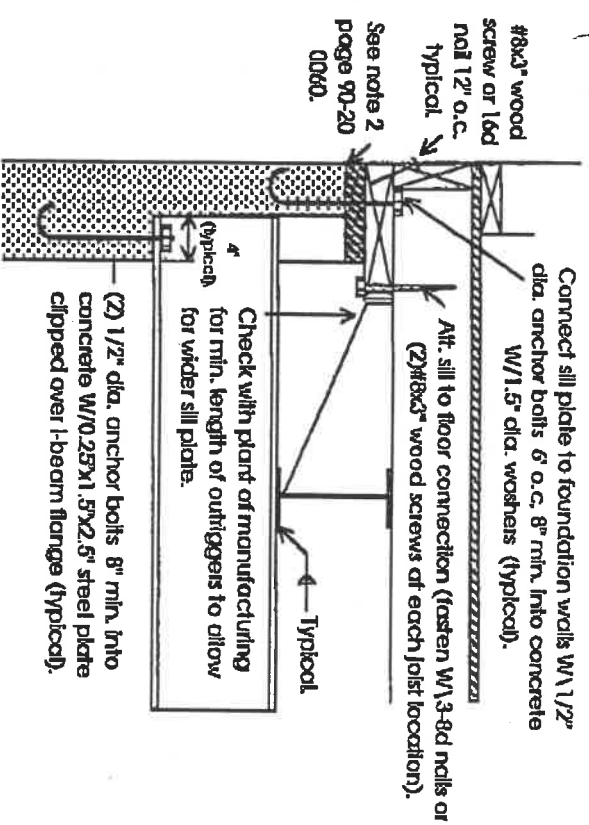

**SECTION B-B**  
Main unit to foundation connections at sidewalls.

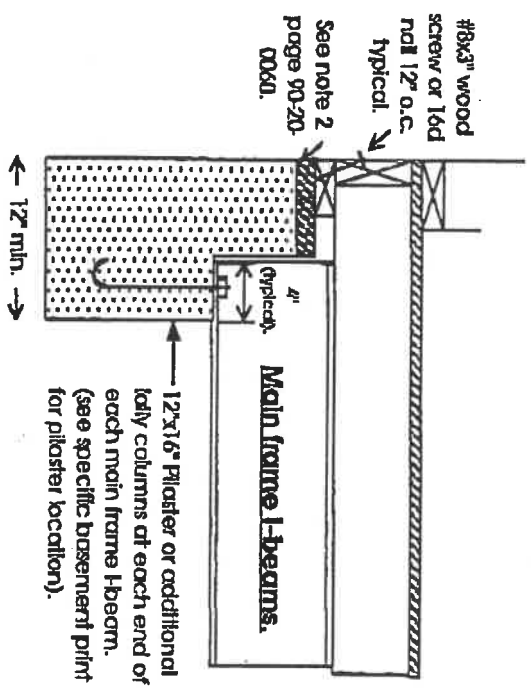

**SECTION C-C**  
Main unit to foundation connections at endwalls.

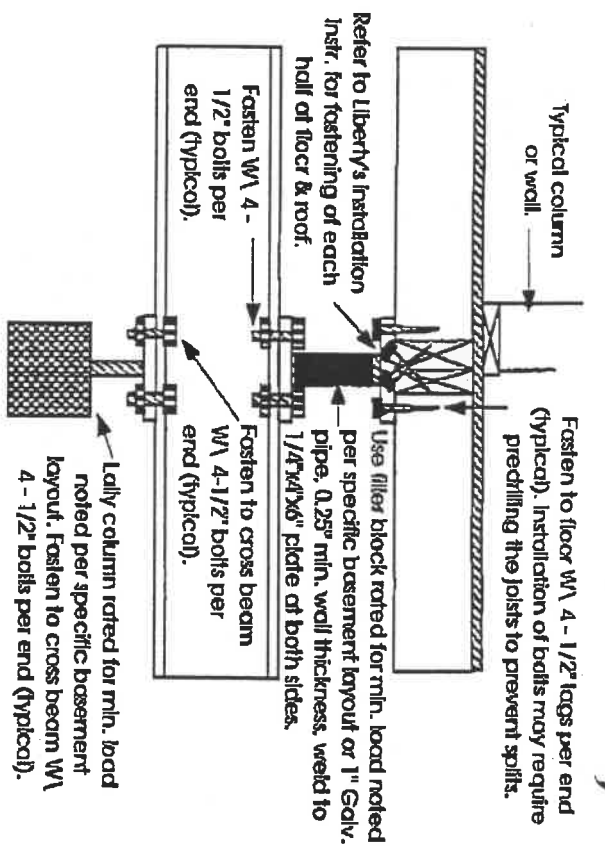

**Lally column to cross beam & floor connection (typical)**

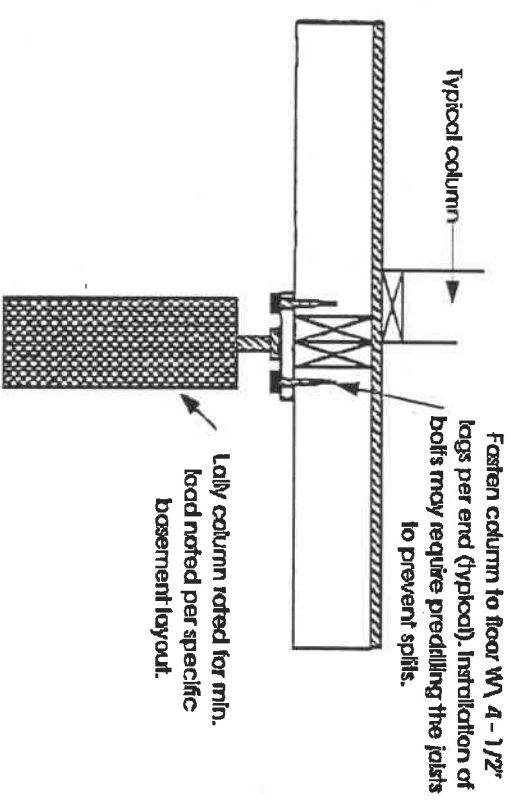

**Lally column to floor connection**  
(typical when no cross beam is specified under floor)



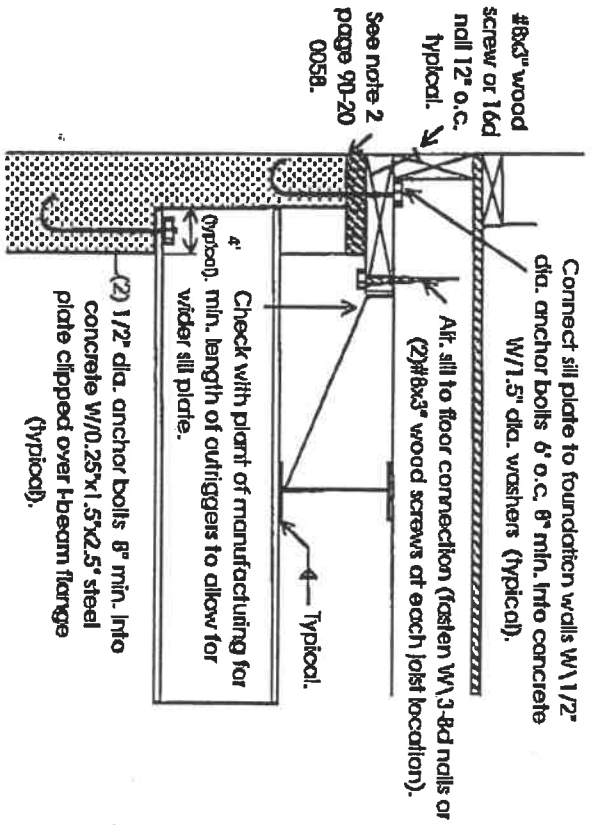

**SECTION 'B-B'**

**Main unit to foundation connections of sidewalls.**

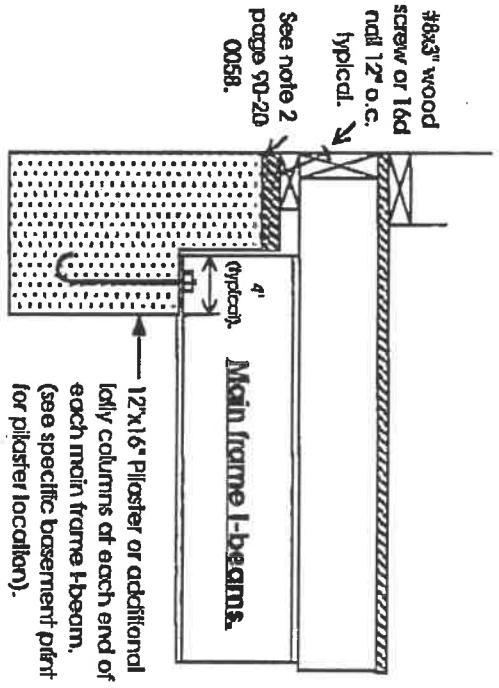

**SECTION 'C-C'**

**Main unit to foundation connections of endwalls.**

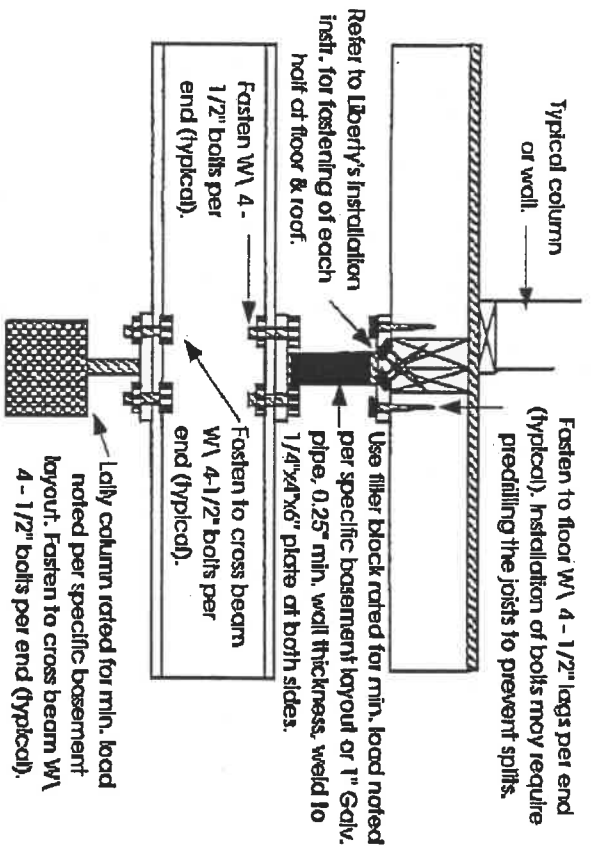

**Lally column to cross beam & floor connection (Typical)**

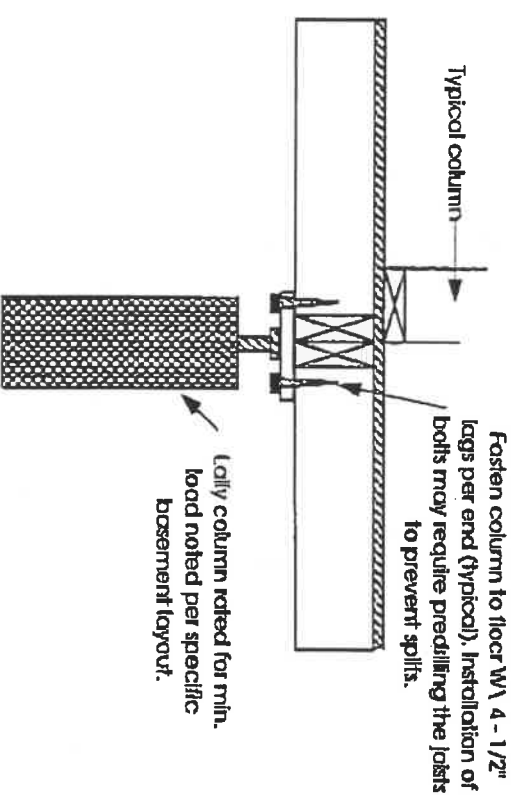

**Lally column to floor connection (Typical when no cross beam is specified under floor)**



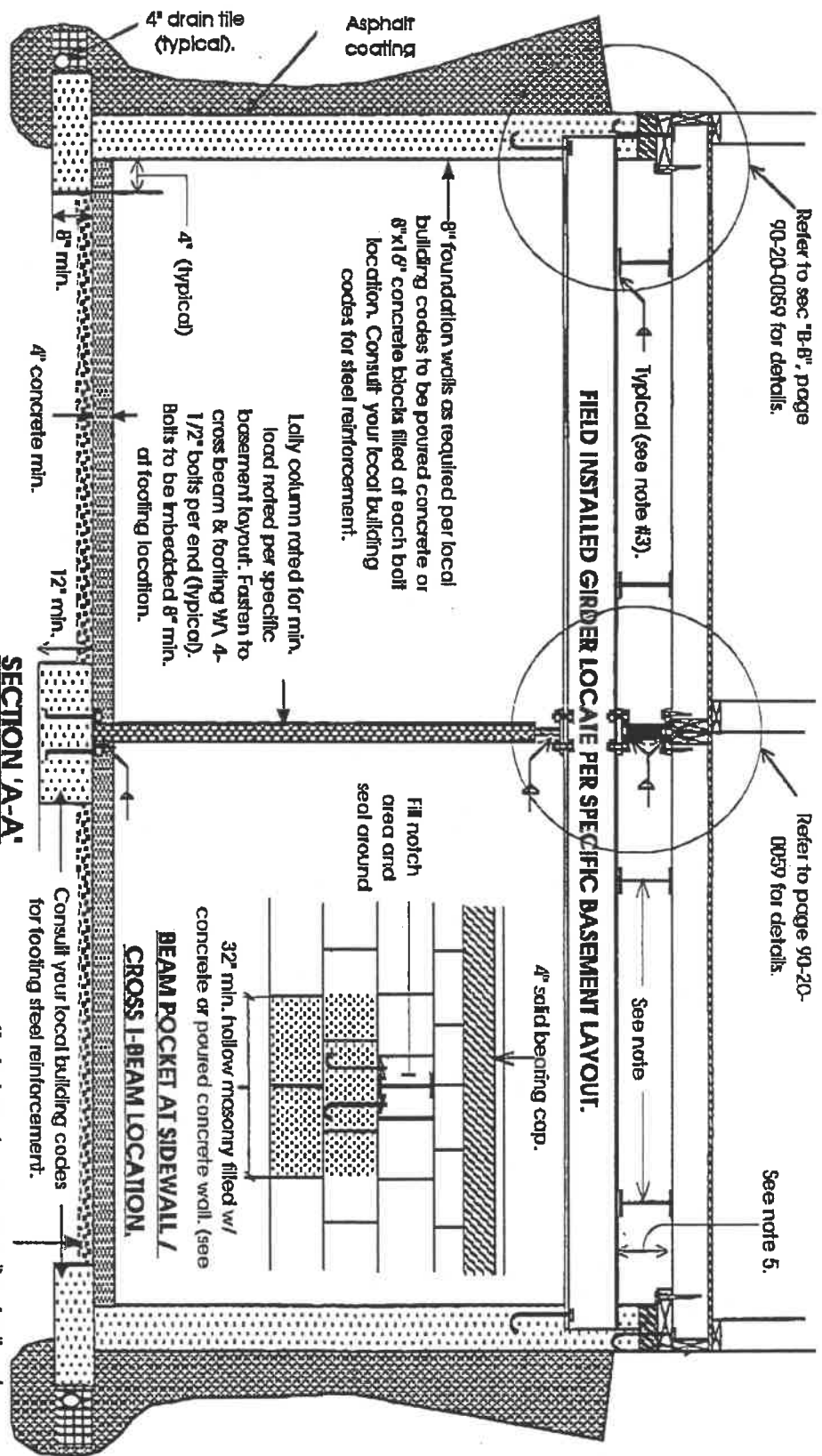

**NOTES:**

1. Basement walls & footings to be designed and constructed to meet local soil conditions, energy and building codes.
2. Foundation walls may be poured concrete (3000 psi min.) or 8"x16" precast concrete blocks for basement use. Blocks must be filled with concrete (32" min. x ht. of basement wall) at each anchor bolt & cross beam location. Block must be capped with 4" solid concrete.
3. All welds to be E-70 1/8" min. fillet, full width.

4. Optional 12"x16" concrete pilasters may be used at transverse girder & foundation wall location.
5. Dimension varies with unit I-beam size. See your specific basement layout for size of I-beams.
6. Applicable to wind zone 1 only.
7. Refer to Liberty's installation instructions for all other informations.



# Lawrence S. Koesters

219 East Washington St.  
Ste. 200  
Napoleon, Ohio 43545

Office: (419)592-2103  
Office Fax: (419)592-8151  
Home Fax: (419)599-0203  
Cellular: (419)783-9767  
e-mail: larrykoesters@hotmail

---

To: Brent D.

Is this what you need for HUD  
approval.

This is what I was faxed when I  
made the request.

Please advise @ 599-5540

Thanks

Lang.

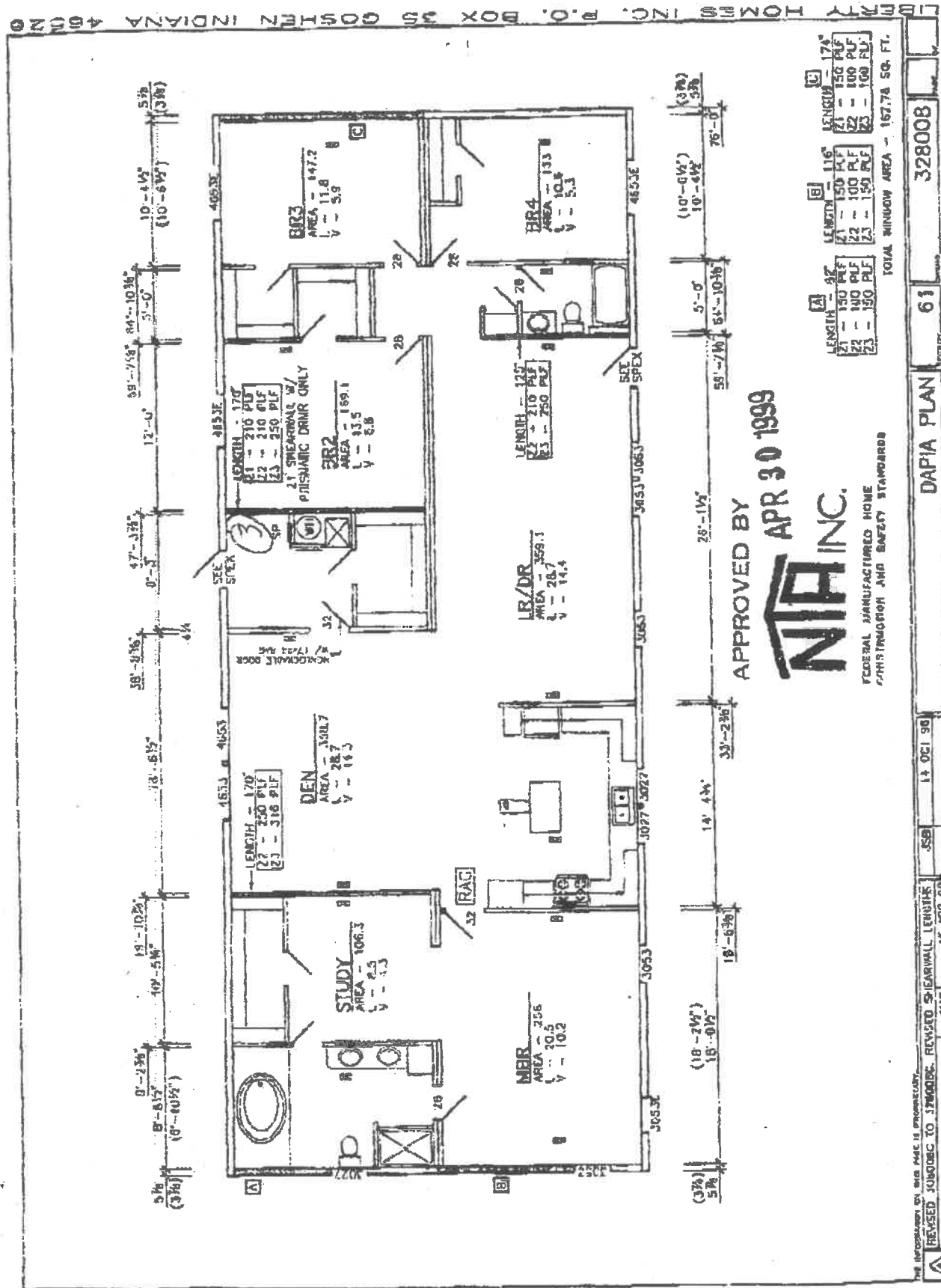



*All: Beant Damon  
From Tim Davis / Liberty  
Homes*

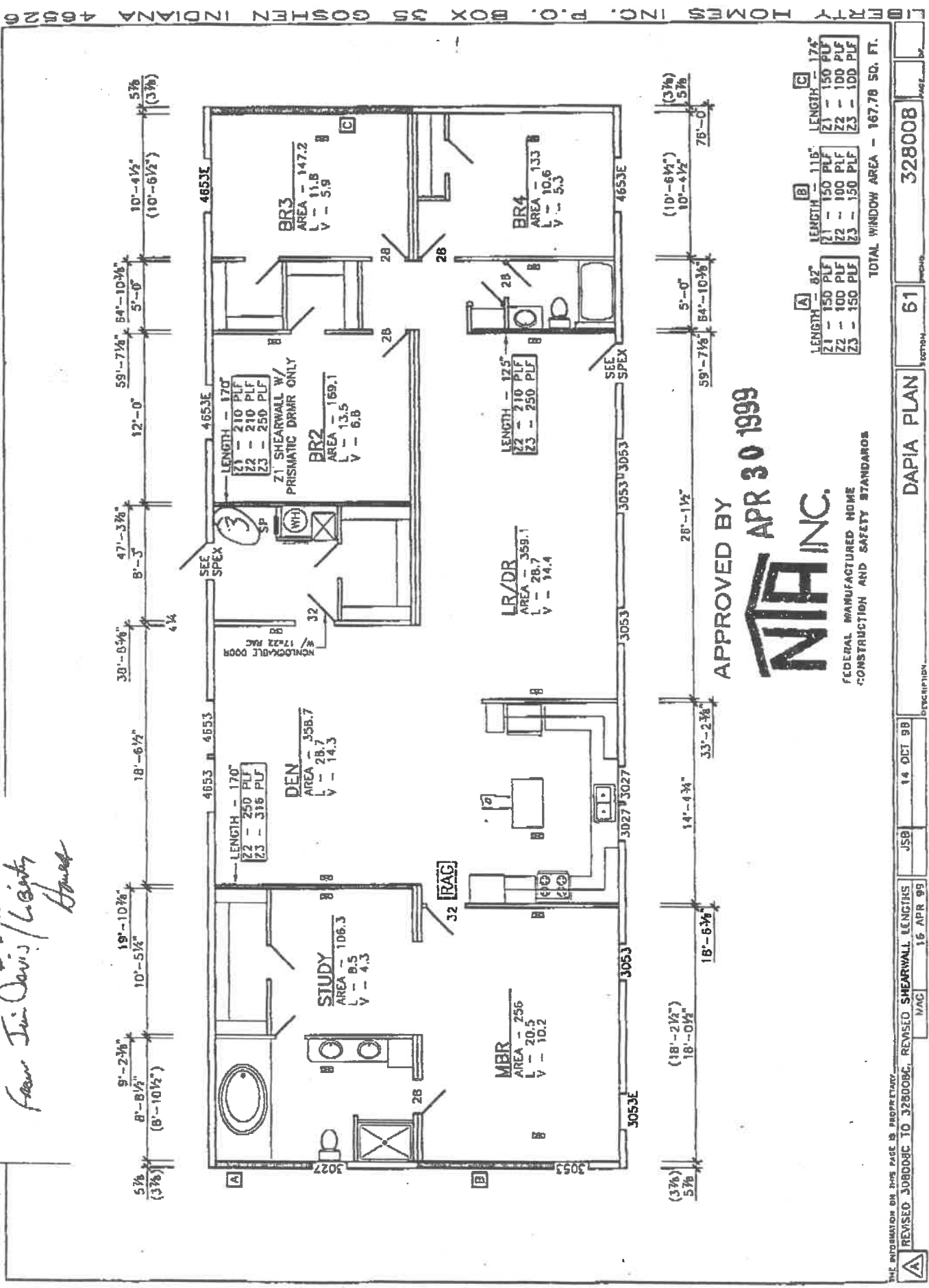

APPROVED BY  
**NIA INC.**  
APR 30 1999

FEDERAL MANUFACTURED HOME  
CONSTRUCTION AND SAFETY STANDARDS

TOTAL WINDOW AREA - 167.78 SQ. FT.

THE INFORMATION ON THIS PAGE IS PROPRIETARY.	REVISION	DATE	DESCRIPTION
REVISED 30BDDBC TO 32BDDBC.	JSD	14 OCT 99	
	MAC	15 APR 99	
DAPIA PLAN			61
328008			